

-8/c-

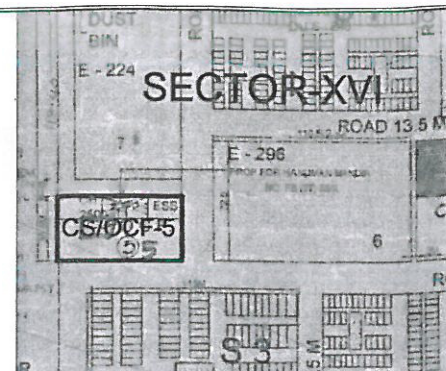

दिल्ली विकास प्राधिकरण
DELHI DEVELOPMENT AUTHORITY
रोहिणी योजना कार्यालय
ROHINI PROJECT PLANNING OFFICE



KEY PLAN

AREA STATEMENT

TOTAL AREA OF PLOT = 2523.28 SQ.M.

DETAILS OF PLOT :

PLOT NO.	USE	AREA (IN SQ.M.)
1	DISPENSARY	846.50
2	RELIGIOUS	371.80
3	11 KV E.S.S.	80.35
4	C.S.C.	1088.61
5	MB/VB	112.00
CIRCULATION (3 M. WIDE PATH)		24.02

- NOTES:
- THIS DRAWING IS BASED ON P.T. SURVEY SUPPLIED BY D.D. (SURVEY), ROHINI ON 17.10.2014.
 - DEVELOPMENT CONTROL NORMS ARE AS PER MPD-2021
 - ALL DIMENSIONS ARE IN METRES.
 - ONLY WRITTEN DIMENSIONS ARE TO BE FOLLOWED
 - THE SCHEME WAS APPROVED IN THE 328TH SCREENING COMMITTEE MEETING HELD ON 24.02.2015 VIDE ITEM NO. 15:2015.

The Proposal has been approved by the 328th Screening Committee held on 24.02.15 vide item No. 15:2015 in File No. PP/R/1031/LS-CS/93/791/PT-II

DELHI DEVELOPMENT AUTHORITY
HUPW-CO-ORDINATION UNIT
VERIFIED
This proposal was considered in the 328th Screening Committee Meeting held on 24.02.2015 vide item no. 15:2015

DELHI DEVELOPMENT AUTHORITY
CERTIFIED
Approved in 328th Screening Committee Meeting Dt. 24.02.15 vide Item No. 15:2015
Sign: *[Signature]*
Name: N.R. Arvind
Designation: Director (Plg.) R

KJL 7/4/15 (KAWALJEET) Plg. Asstt.
[Signature] 7/4/15 (Anita Dewan) A.D. (Plg.) R
[Signature] 08/04/15 (A.K. Malhotra) Dy. Dir. (Plg.) R

FILE No: PP/R/1031/LS-CS/93/791/PT. II

MODIFICATION IN LAYOUT PLAN OF CS/OCF-5, SECTOR-XVI, ROHINI, PHASE-I & II

SCALE	1:500	
DATE	APRIL, 2015	
योजना सहायक PLG. ASSTT	<i>[Signature]</i>	सहायक निदेशक ASSTT. DR. (PLG.) (ON CONTRACT)
सहायक निदेशक (योजना) ASSTT. DR. (PLG.)	<i>[Signature]</i>	
अधीन निदेशक (योजना) DY. DR. (PLG.)	<i>[Signature]</i>	
निदेशक (योजना) DIRECTOR (PLG.)		

रोहिणी
ROHINI
योजना कार्यालय नई दिल्ली 110085
PLANNING OFFICE, NEW DELHI 110085

ड्रॉग नं. DRG NO
1/CS-OCF-5XVI

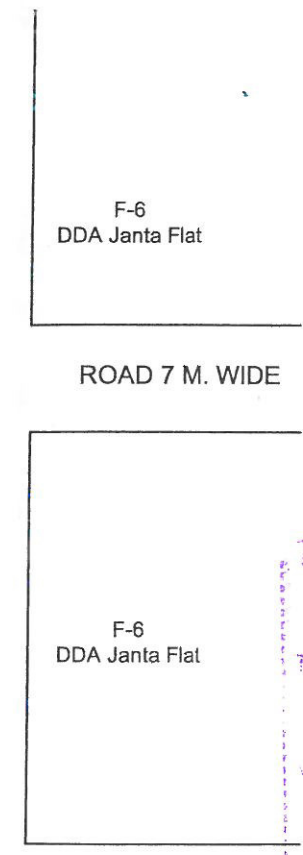
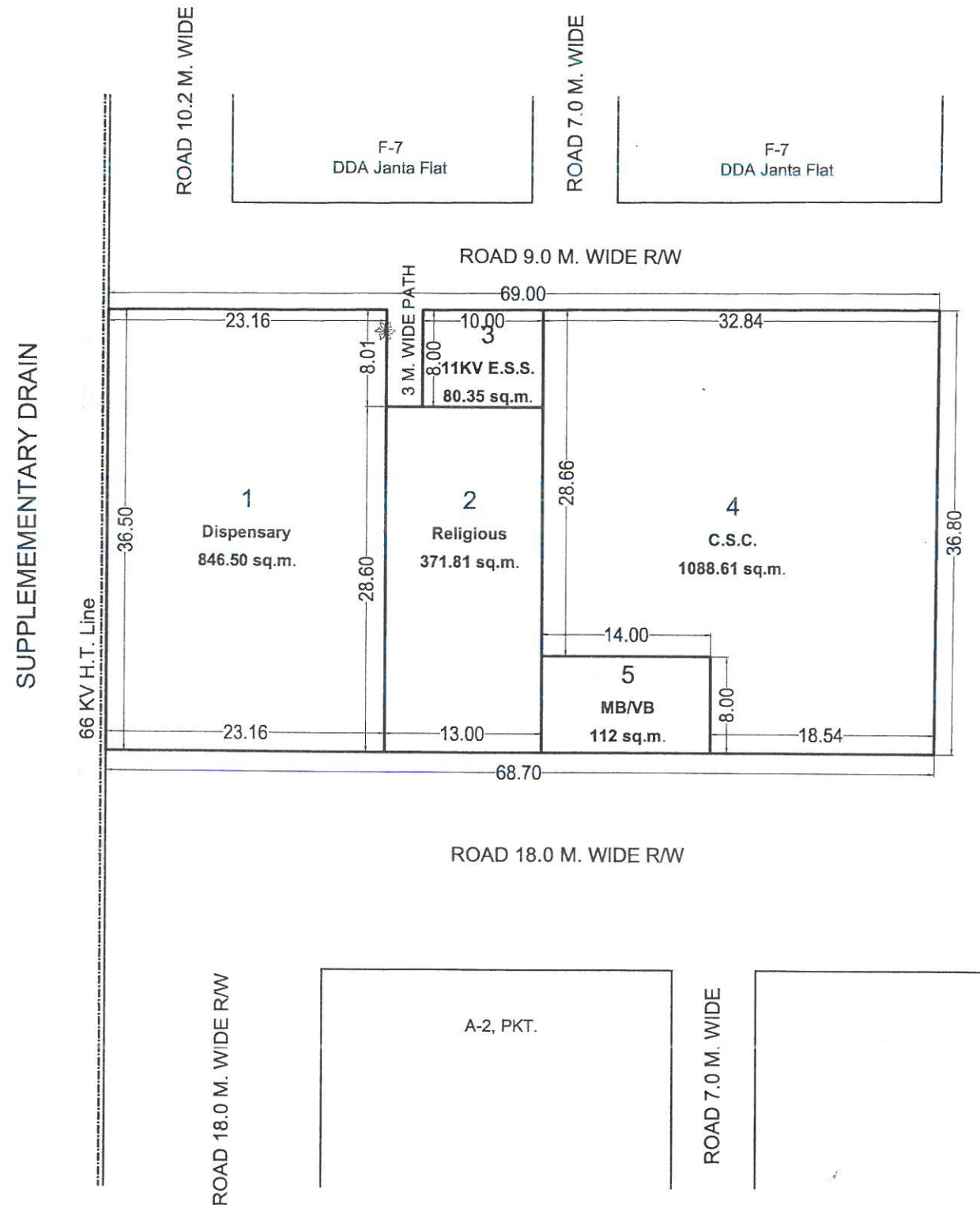

DELHI DEVELOPMENT AUTHORITY
HUPW-CO-ORDINATION UNIT
VERIFIED
This proposal was considered in the 328th Screening Committee Meeting held on 24.02.2015 vide item no. 15:2015

[Signature] 7/3/15
Dy. Director (Arch.) Coord